



AVENTOS HK-XS

> Compact fitting, great convenience



AVENTOS HK-XS

AVENTOS HK-XS is a compact stay lift fitting with a sleek and narrow design. It is ideally suited for applications in high wall cabinets with low heights and shallow internal depth. AVENTOS HK-XS lifts opens and closes with a seemingly weightless movement. AVENTOS HK-XS offers an economical solution whilst featuring the familiar AVENTOS quality of motion.



Silent closing

AVENTOS HK-XS is combined with CLIP top BLUMOTION hinges for silent and effortless closing.



Numerous possibilities

Whether thick wooden fronts or wide aluminium frames, the fixing positions always remain the same. This allows different materials and front thicknesses to be easily integrated.



Proven Blum quality

The core element of the compact fitting is the robust spring package that ensures high stability and durability for the lifetime of the furniture.



Large, heavy fronts

Wide and heavy fronts can be used when the lift mechanism is installed on both sides of the cabinet.



CLIP mechanism

The lift mechanism can be assembled tool-free using the CLIP technology.



AVENTOS HK-XS: BLUMOTION application

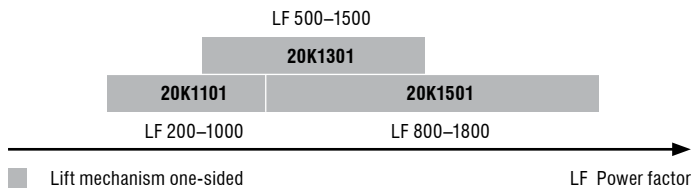

Power factor LF = cabinet height KH (mm) x front weight incl. double handle weight (kg)
The power factor is doubled when used on two sides. A trial application is recommended when you are in a borderline area of the individual lift mechanism.

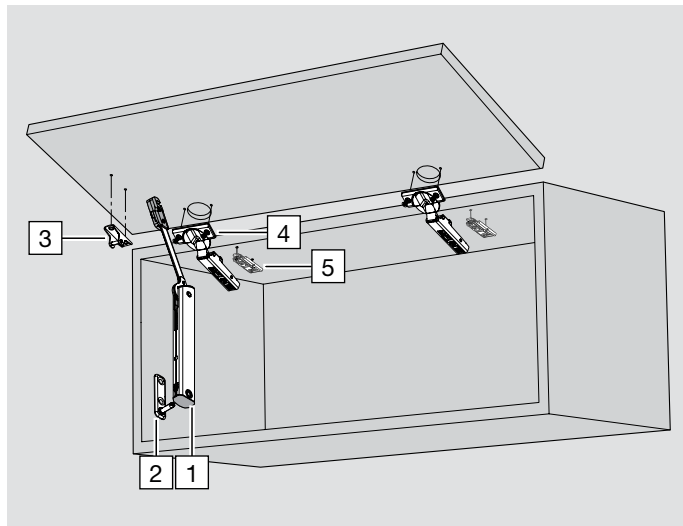

1	Symmetrical lift mechanism (suits BLUMOTION)		
	Power factor	Blum No	LS Code
	200-1000	20K1101	1-320-180
	500-1500	20K1301	1-320-182
	800-1800	20K1501	1-320-184
105° opening angle*			

2	Cabinet fixing		
		Blum No	LS Code
	Screw-on	20K5101	1-320-173
	EXPANDO	20K51E1	1-320-176
Nickel plated steel, one required per mechanism			

3	Front fixing bracket		
		Blum No	LS Code
	Screws ¹⁾	20K4101	1-320-171
	EXPANDO	20K41E1	1-320-174
Nickel plated steel, one required per mechanism			



4	Hinge recommendation ²⁾		
	CLIP top BLUMOTION 110°	Blum No	LS Code
	INSERTA	With spring	71B3590 1-308-71B359
	Screw-on	With spring	71B3550 1-308-71B355
	Knock In	With spring	71B3580 1-308-71B358
	E Dowel	With spring	71B358E 1-308-71B358E
Minimum 2 hinges required per door (with spring) For more hinge options view Lincoln Sentry Cabinet Hardware catalogue section B Hinges sold as Each			

5	Mounting plate recommendation Horizontal cam mounting plate			
	Fixing	Spacing	Blum No	LS Code
	Screw-on Supplied 2 per bag	0 mm	175H3100	1-317-5H3100V2
	E Dowel Supplied as Each	0 mm	177H3100E	1-317-7H3100E
One required per hinge For more mounting plate options view Lincoln Sentry Cabinet Hardware catalogue section B				

- Use 2 chipboard screws for wooden fronts. Use 2 countersunk self-tapping screws for wide aluminium frames.
 - Alternatively, use the CLIP top BLUMOTION hinges, 95° profile door hinges or the CLIP top hinges 107°, 95° profile door hinges in combination with clip-on BLUMOTION 973A.
- * For hinges with smaller opening angles, these are limited by the hinges.

Accessories

Hinge arm cover cap			
	Blum Stamped	Blum No	LS Code
		70.1503.BP	1-311-510

Hinge boss cover cap			
	CLIP top BLUMOTION	Blum No	LS Code
		70T3504	1-331-504

Hinge boss spacing (Suits Screw-on only)			
	CLIP top BLUMOTION Nylon, 1.5 mm, sold per box of 250	Blum No	Code
		70T3507.21	1-331-555

Opening angle stop 86°			
	Nylon	Blum No	Code
		70T3553	1-331-553

AVENTOS HK-XS: TIP-ON application

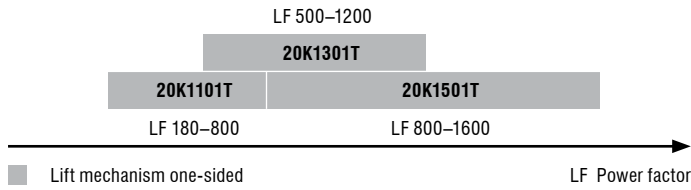

Power factor LF = cabinet height KH (mm) x front weight incl. double handle weight (kg)

The power factor is doubled when used on two sides. A trial application is recommended when you are in a borderline area of the individual lift mechanism.

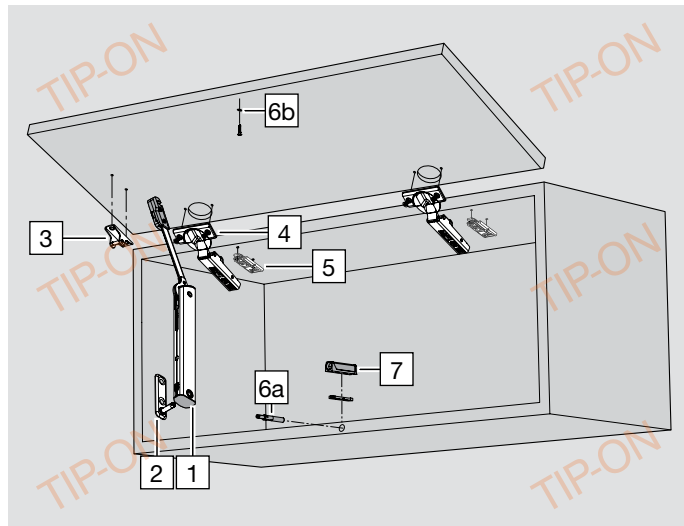

1	Symmetrical lift mechanism (suits TIP-ON)		
	Power factor	Blum No	LS Code
	180-800	20K1101T	1-322-180
	500-1200	20K1301T	1-322-182
	800-1600	20K1501T	1-322-184
105° opening angle*			

2	Cabinet fixing		
		Blum No	LS Code
	Screw-on	20K5101	1-320-173
	EXPANDO	20K51E1	1-320-176
Nickel plated steel, one required per mechanism			

3	Front fixing bracket		
		Blum No	LS Code
	Screws ¹⁾	20K4101	1-320-171
	EXPANDO	20K41E1	1-320-174
Nickel plated steel, one required per mechanism			

4	Hinge recommendation			
	CLIP top 120° for TIP-ON		Blum No	LS Code
	INSERTA	Unsprung	70T5590BTLMB	1-308-70T559
	Screw-on	Unsprung	70T5550.TL	1-308-70T555
<i>minimum 2 hinges required per door (without spring) For more hinge options view Lincoln Sentry Cabinet Hardware catalogue section B Hinges sold as Each</i>				



5	Mounting plate recommendation Horizontal cam mounting plate			
	Fixing	Spacing	Blum No	LS Code
	Screw-on <i>Supplied 2 per bag</i>	0 mm	175H3100	1-317-5H3100V2
	E Dowel <i>Supplied as Each</i>	0 mm	177H3100E	1-317-7H3100E
<i>One required per hinge For more mounting plate options view Lincoln Sentry Cabinet Hardware catalogue section B</i>				

6	TIP-ON set			
			Silk white (SW)	Terra black (TB)
		Blum No	LS Code	LS Code
		956.1004	1-311-205	1-311-405
<i>For drilling Ø 10 x 50 mm Plastic Short version, length 50 mm</i>				
Consisting of:				
1 x TIP-ON 1 x screw-on catch plate ²⁾ 1 x chipboard screw 609.1500				

7	Horizontal adapter plate			
			Silk white (SW)	Terra black (TB)
		Blum No	LS Code	LS Code
		956.1201	1-311-206	1-311-406
<i>Suits short (50mm) TIP-ON mechanism Supplied as Each</i>				

¹⁾ Use 2 chipboard screws for wooden fronts. Use 2 countersunk self-tapping screws for wide aluminium frames.

²⁾ Note: The glue-on catch plate should not be used in combination with TIP-ON for AVENTOS HK-XS.

* For hinges with smaller opening angles, these are limited by the hinges.

Accessories

	Hinge arm cover cap		
	Blum Stamped	Blum No	LS Code
		70.1503.BP	1-311-510

Planning Information

Cabinet positions for lift mechanism

$H = 137 + D + K + SOB$
D Mounting plate spacing
K Hinge crank
 Horizontal hinge arm 0 mm
 Cranked hinge arm 9.5 mm
 Double cranked hinge arm 18 mm
SOB Top panel thickness

Space requirement

LH Internal cabinet height
 min LH = 200
 min 125* (min 100*)
 27

Front assembly

Wooden fronts and wide aluminium frames¹⁾
 ⚓ $\varnothing 3.5 \times 15$ mm
FAo Upper front overlay
SFA Side front overlay

Number of hinges
 3 hinges starting at cabinet width 900 mm and/or power factor 1800
 4 hinges starting at cabinet width 1200 mm and/or power factor 2700

Space requirement

$Y = (FH - a) \times 0.3$

FD (mm)	16	19	22	24
a (mm)	45	34	23	15

FD Front thickness
FH Front height

- ¹⁾ Use 2 chipboard screws for wooden fronts.
Use 2 countersunk self-tapping screws for wide aluminium frames.
- () Special drilling positions for a minimum internal depth of 100 mm
- i** To ensure optimal motion, use standard drilling positions for a minimum internal depth of 125 mm

Cornice and crown moulding clearance

FD (mm)	16	19	22	24
x (mm)	45	34	23	15

FD Front thickness

Minimum gap (F) for fronts with a front radius (R = 1 mm) based on the factory setting for CLIP top BLUMOTION 110°

TB	Front thickness FD										28	30
	16	18	19	20	21	22	23	24	25	26		
TB	3	0.5	0.8	1.0	1.2	1.5	1.8	2.2	2.7	3.5	4.3	A trial application is recommended
	4	0.5	0.8	1.0	1.2	1.4	1.7	2.0	2.5	3.1	3.8	
	5	0.5	0.8	0.9	1.2	1.4	1.7	2.0	2.4	2.9	3.4	
	6	0.5	0.8	0.9	1.2	1.3	1.6	1.9	2.3	2.7	3.2	
	7	0.5	0.8	0.9	1.1	1.3	1.6	1.9	2.2	2.6	3.0	
Additional for + 2 mm side adjustment												
	+0.2	+0.4	+0.4	+0.5	+0.5	+0.5	+0.5	+0.5	+0.5	+0.5	+0.5	

Minimum gap

MFu Minimum gap at the bottom (1.5 mm)
MFo Minimum gap at the top depending on hinge used

CLIP top BLUMOTION 110°

TB	Front overlay FA													
	5	6	7	8	9	10	11	12	13	14	15	16	17	18
TB	0									3	4	5	6	7
	3						3	4	5	6	7			
	6			3	4	5	6	7						
	9	3	4	5	6	7								

⬆ Mounting plate

CLIP top BLUMOTION 110°

F Gap
FA Front overlay
TB Drilling distance

Planning Information: TIP-ON

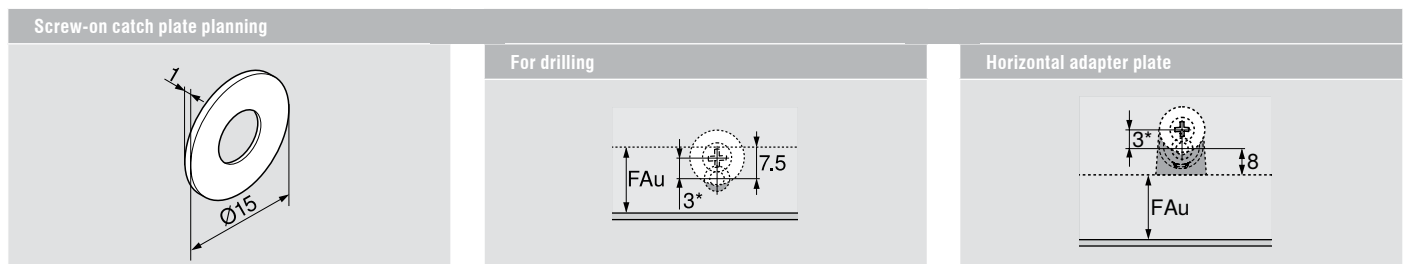
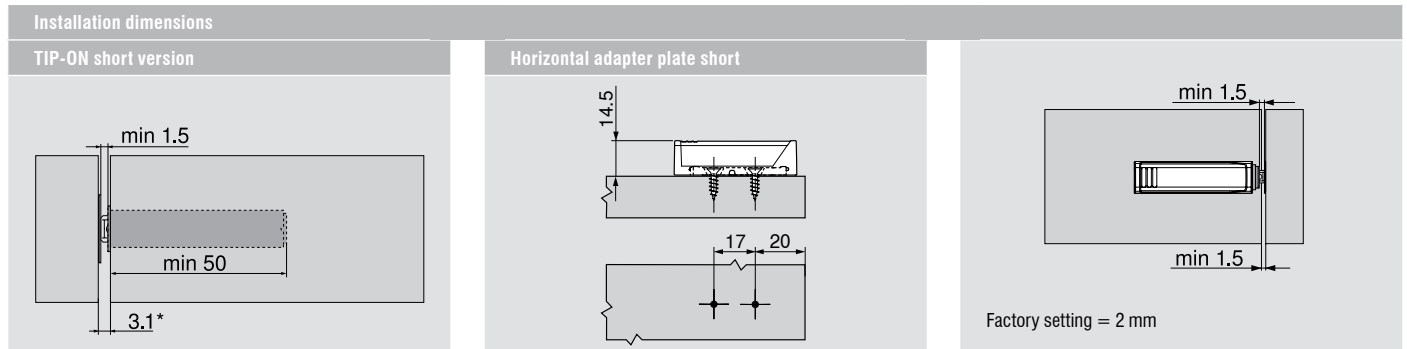
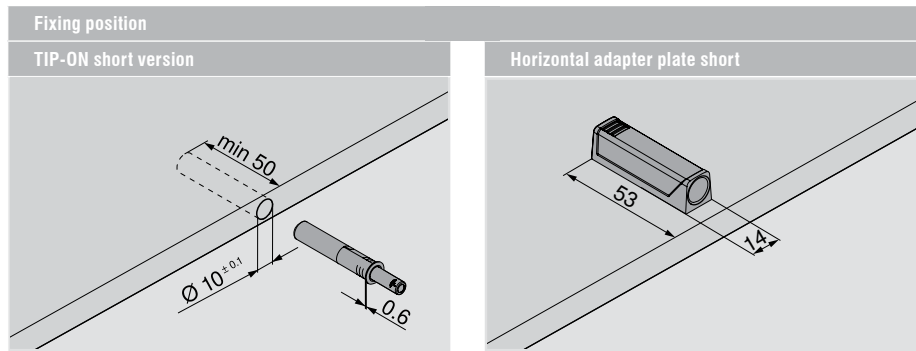

FAu Lower front overlay

* We recommend offsetting the positioning of TIP-ON by 3 mm for the screw-on catch plate.

Note: the glue-on catch plate should not be used in combination with TIP-ON for AVENTOS HK-XS.

Assembly Devices

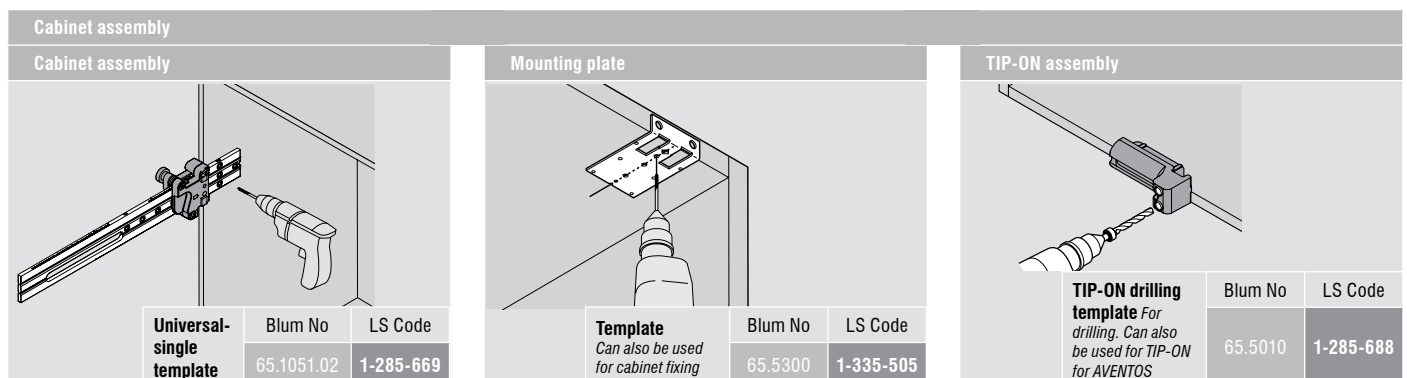
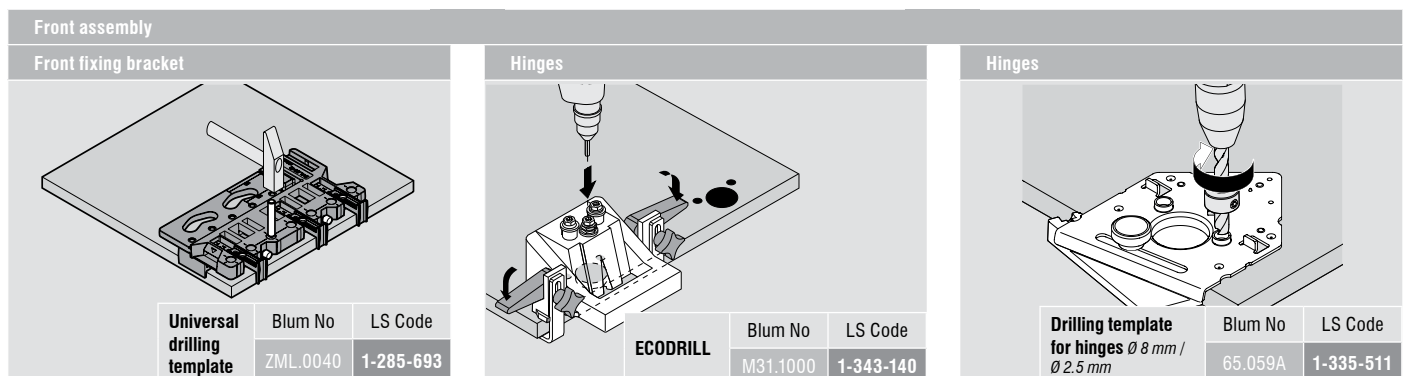



National Customer Service:
Ph: 1300 551 919
Fax: 1300 739 656

www.lincolnsentry.com.au

Scan QR code to find
your nearest branch



For locations please visit
<http://www.lincolnsentry.com.au/contact-us/locations>

